



ASPIRE

— TO MOVE —



Monmouth Place, Upper Bristol Road, Bath, BA1

Video viewing and physical viewings available. Second floor, one bedroom part-furnished apartment located on Monmouth Place, Bath. Available now.

Monmouth Place is located just west of Bath city centre, 0.2 miles away from Queen Square. Local shops can be found in the city centre and the nearest supermarket is Sainsbury's which is a 5 minute walk away. Royal Victoria Park is 0.2 miles away and there is a bus stop just outside the apartment.

- Video viewing available
- One bedroom flat
- Available now
- Part-furnished
- Council tax band A
- Holding deposit: £265
- Students considered

£1,150 PCM

Floor Plans

SECOND FLOOR
346 sq.ft. (32.1 sq.m.) approx.

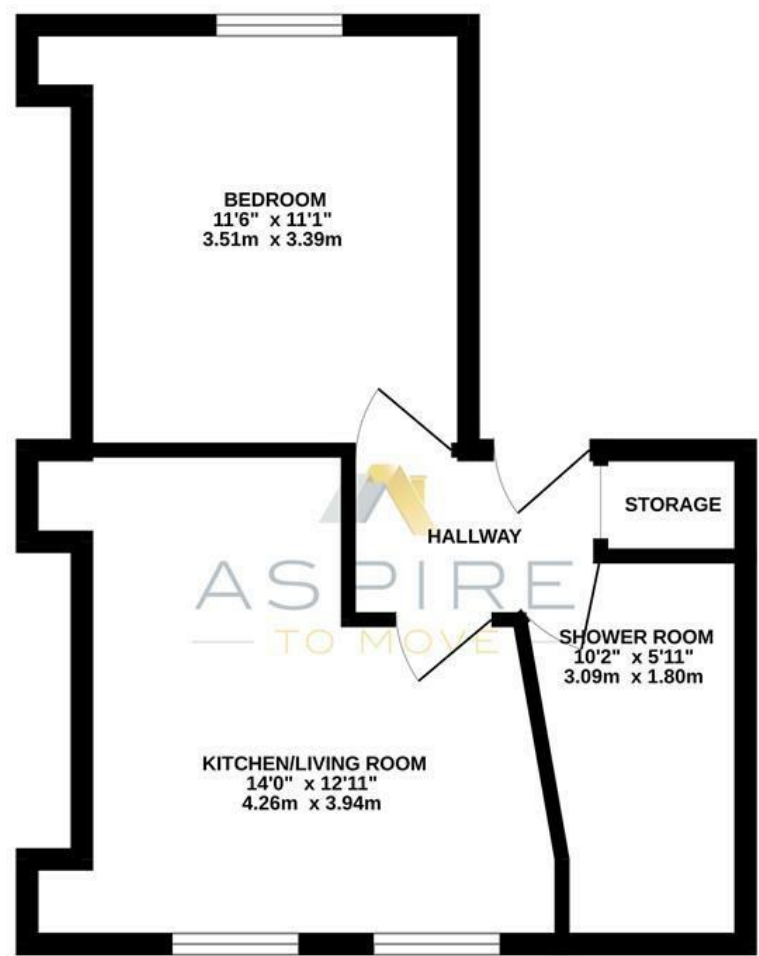

MONMOUTH COURT, BATH, BA1

TOTAL FLOOR AREA: 346 sq.ft. (32.1 sq.m.) approx.

Whilst every attempt has been made to ensure the accuracy of the floorplan contained here, measurements of doors, windows, rooms and any other items are approximate and no responsibility is taken for any error, omission or mis-statement. This plan is for illustrative purposes only and should be used as such by any prospective purchaser. The services, systems and appliances shown have not been tested and no guarantee as to their operability or efficiency can be given.
Made with Metropix ©2025

Energy Performance Graph

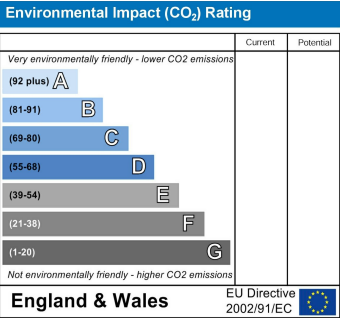
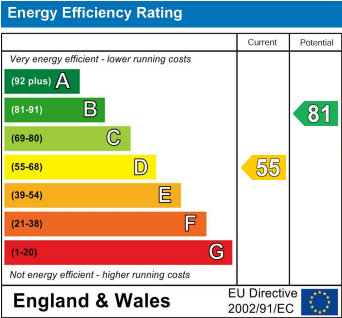

These particulars, whilst believed to be accurate are set out as a general outline only for guidance and do not constitute any part of an offer or contract. Intending purchasers should not rely on them as statements of representation of fact, but must satisfy themselves by inspection or otherwise as to their accuracy. No person in this firms employment has the authority to make or give any representation or warranty in respect of the property.